

OneDrive Configuration

1. Login to OneDrive
 - a. Use O365 Login credentials (User info will auto-fill)
 - i. Employee = <StarID>@minnstate.edu
 - ii. Student = <StarID>@go.minnstate.edu

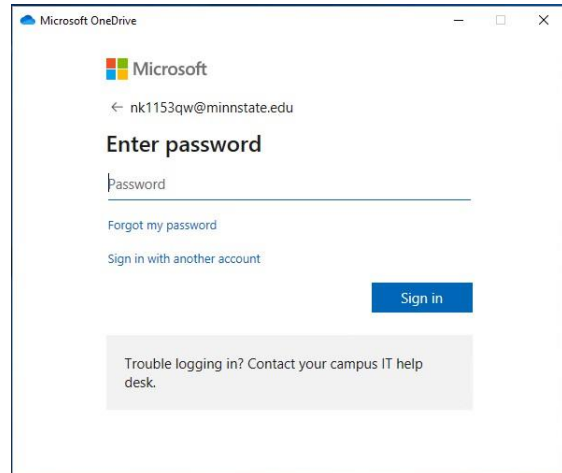

2. Click thru the Setup/information screens
 - a. Select "Open my OneDrive folder"

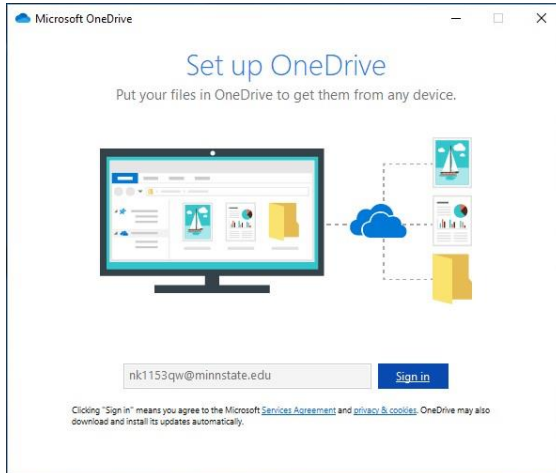
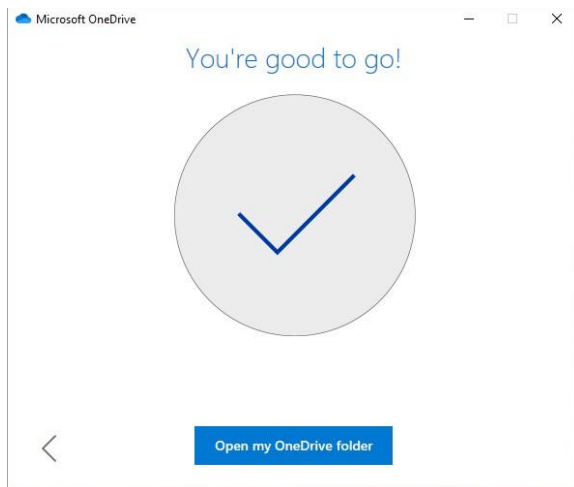

3. The Shared Tenant OneDrive configuration display in File Explorer
 - a. OneDrive – MNSCU

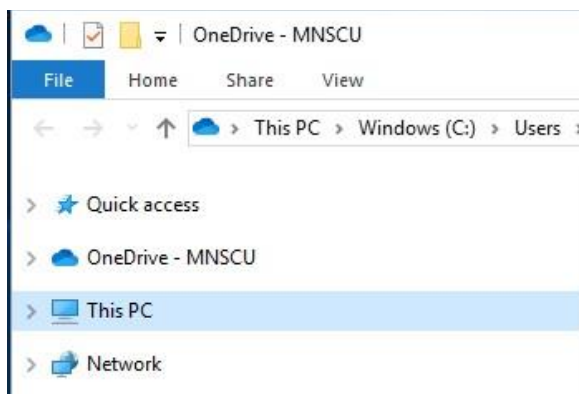

OneDrive Configuration